



# 396-7182Y1

## Universal Load Boom Installation Instructions

**Kit Number: 610-07-100100**

**Kit Description: Universal Load Boom Mounting Kit**

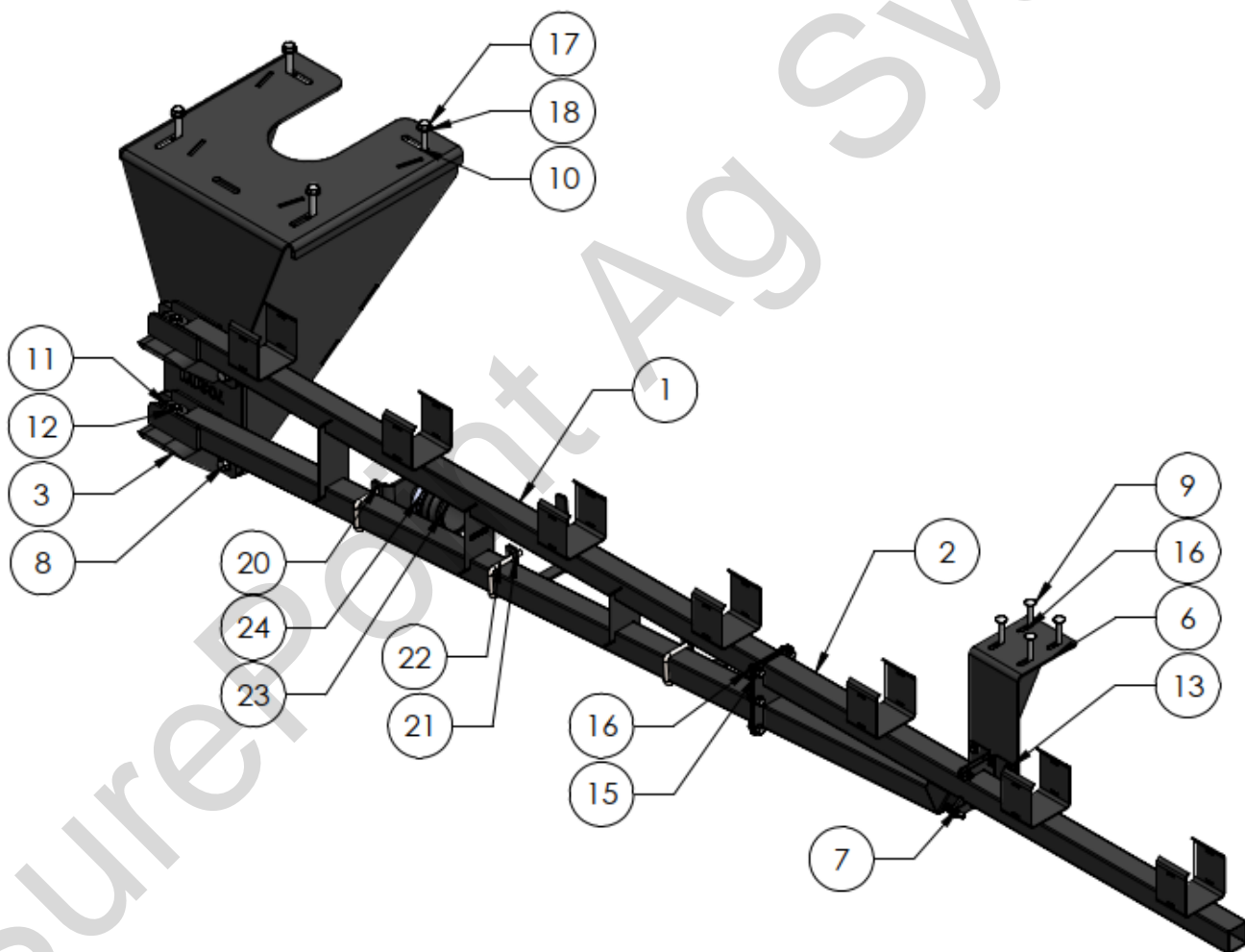



# Bill of Materials

**Kit Number: 610-07-100100**

**Kit Description: Universal Load Boom Mounting Kit**

ITEM NO.	PART NUMBER	DESCRIPTION	QTY.
1	475-6774Y1	Boom Mounting Section	1
2	475-6787Y1	Boom Extension Section	1
3	475-6783Y1	Boom Hinge	2
4	757-1677K22	Low-Friction Oil Embedded Sleeve Bearing	2
5	475-7021Y1	Universal Boom Mounting Bracket	1
6	475-7015Y1	Universal Latch Mounting Bracket	1
7	476-6798Y1	Boom Latch Assembly	1
8	307-080108-5	1/2" x 1-1/2" Flange Head Bolt - G5	8
9	304-060300-5	3/8" x 3" Carriage Bolt - G5	4
10	325-08	1/2" Top Lock Flange Nut - G5	14
11	475-6797Y1	Boom Hinge Washer	2
12	300-080208-5	1/2" x 2-1/2" Hex Head Bolt - G5	2
13	307-050012-SS	5/16" x 3/4" Flange Head Bolt - SS	4
14	323-05-SS	5/16" Flange Nut - SS	4
15	307-060012-5	3/8" x 3/4" Flange Head Bolt - G5	6
16	321-06-F	3/8" Nylon Flange Nut	10
17	300-080300-5	1/2" x 3" Hex Head Bolt - G5	4
18	330-08	1/2" Flat Washer	4
19	353-30WL	Size 30 Wraplock Band (Qty. 10)	1
20	475-6805Y1	Fill Coupler Boom Mount	1
21	475-6804Y1	Boom Hose Mount	2
22	380-1107	3/8" U-Bolt Kit - fits 2" x 2" tube	3
23	105-300A	3" Flange x 3" Male Camlock	1
24	105-FC300	3" Manifold Clamp	1

# Assembly Instructions

**Note:** All the included deck mounting hardware is intended for use on a wood deck trailer. If you have a steel deck trailer, shorter mounting bolts will be needed for successful installation of the boom kit.

1. Press the bushings into the Boom Mounting Section. The bushings will need to be inserted from the bottom, and will require press fitting. Be sure that the bushings are fully seated before proceeding.
2. Assemble the Boom Extension Section to the Boom Mounting Section using the provided 3/8" hardware and tighten to 30 ft-lbs. of torque.
3. Mount the Trailer Mounting Bracket underneath your trailer deck. You will need to drill 1/2" holes through your deck to mount the bracket. Once the bracket is mounted in the desired location, fasten the bracket to the deck using the provided 1/2" hardware. Tighten the 1/2" hardware before proceeding.
4. Loosely bolt the Boom Hinge Brackets to the Trailer Mounting Bracket using the provided 1/2" hardware. Be sure the studs are facing up.

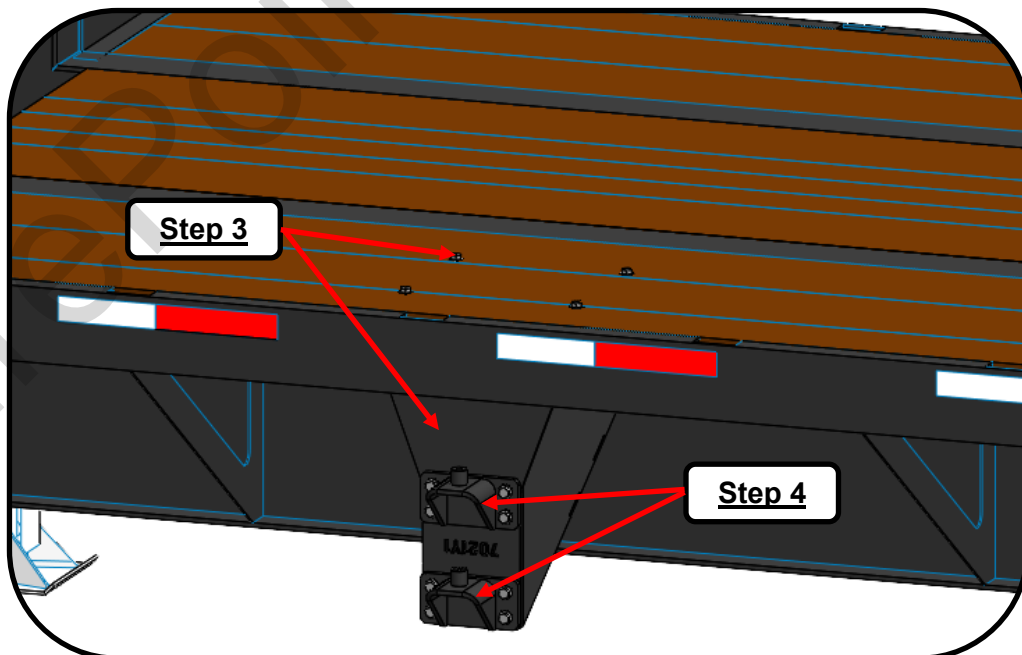
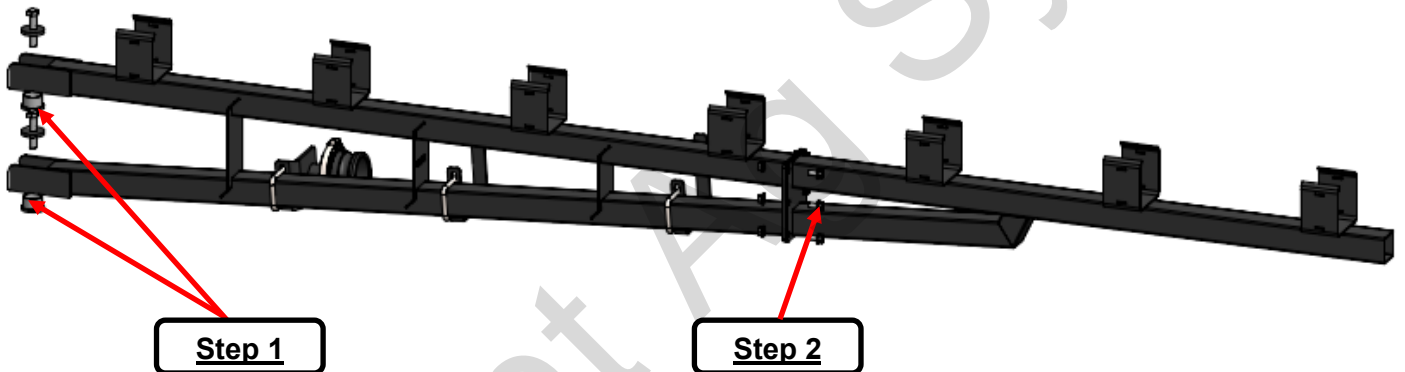

## Assembly Instructions Cont'd.

5. Fasten the assembled boom to the Boom Hinge Brackets and tighten to 60 ft-lbs. using the provided 1/2" hardware and Boom Hinge Washers.
6. Loosely bolt the Boom Latch Assembly to the Latch Mounting Bracket using the provided 5/16" hardware. Be sure that the latching mechanism opens downward to help with hose clearance.
7. Swing the boom shut to where the boom sits parallel to the edge of the trailer deck. Place the latch in the desired location on your boom and lock the latching assembly. Mount the Latch assembly underneath your trailer deck using the provided 3/8" carriage bolts and nuts. You will need to drill 3/8" holes through your deck to mount the bracket. Once the bracket is mounted in the desired location, tighten all latch hardware. Tighten the Boom Hinge Brackets to 60 ft-lbs.
8. Attach the Coupler Hanger and Hose Hanger brackets to the boom using the provided 1/2" u-bolts.
9. Be sure all hardware is properly tightened and boom is properly secured before operation.

