



396-6485Y1

John Deere Pro-Series Opener Rear Delivery Tube Installation Instructions

Part Number: 274-6319Y1

Part Description: John Deere Pro-Series Rear Delivery Tube

Step-by-Step Instructions

1. Loosen the 21mm nut and bolt that mounts the seed packing wheel to the arm until the 274-6319Y1 mounting bracket can fit around the bolt.
2. Mount the tube and ensure that the bottom of the mounting bracket is flush with the bottom of packing wheel arm.
3. Tighten the 21mm nut and bolt back to factory torque specifications.

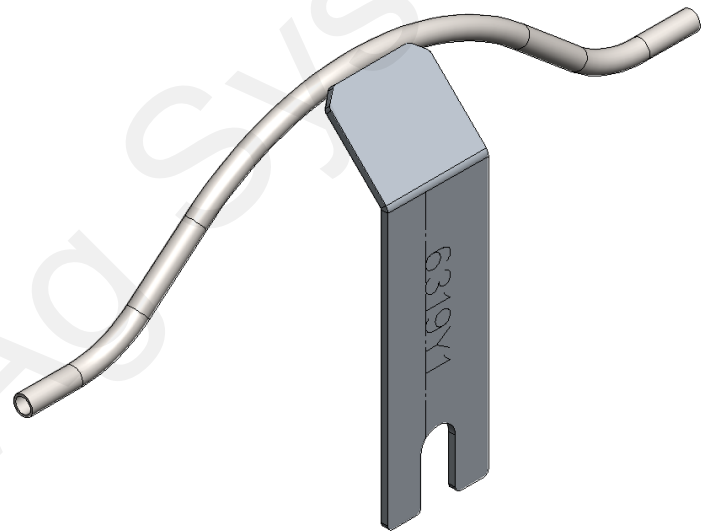

Step 2



Step 1