



396-2883Y1

Plumbing Fill Kit

Installation Instructions

Kit Number: 520-00-101700

Kit Description: *Fill Kit, JD450/600 Factory Tank, 2" Fill Hose*

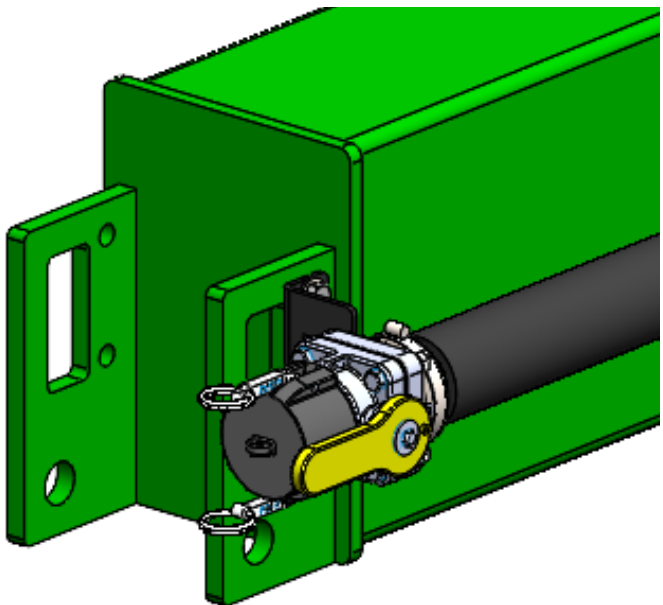
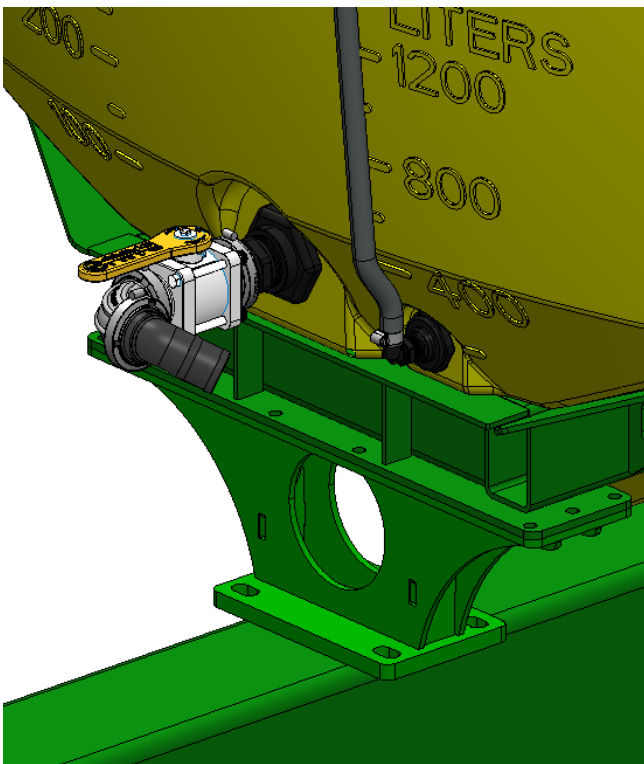

Parts List and Exploded View

ITEM NO.	PART NUMBER	DESCRIPTION	QTY.
1	102-200MVCF	2" Manifold Standard Port Poly Valve	1
2	102-200VSFCF	200 Series Manifold x 2" Male Quick Coupler Standard Port Poly Valve	1
3	105-150G-H	1-1/2" EPDM Manifold Gasket for 200 Series Manifold Fittings	5
4	105-200125MPT	2" Manifold x 1-1/4" MPT	1
5	105-200150MPT	2" Manifold x 1-1/2" MPT	1
6	105-200BRB	2" Manifold x 2" HB	2
7	105-200BRB45	2" Manifold x 2" HB - 45 Degree	1
8	105-200MPT	2" Manifold x 2" MPT	1
9	105-200SWP90	2" Manifold Sweep—90 Degree	1
10	105-FC200	2" Manifold Clamp	4
11	106-200CAP	2" Cap	1
12	280-200-ENF	2" Enforcer Fertilizer Solution Hose	1
13	300-050508-5	5/16" x 5-1/2" Hex Head Bolt - G5	2
14	300-060100-5	3/8" x 1" Hex Head Bolt - G5	4
15	300-080108-5	1/2" x 1-1/2" Hex Head Bolt - G5	2
16	323-05	5/16" Flange Nut	2
17	323-06	3/8" Flange Nut	4
18	323-08	1/2" Flange Nut	2
19	330-05	5/16" Flat Washer	2
20	330-08	1/2" Flat Washer	2
21	350-PS288	Pressure Seal HD Clamp, Size 288 - 2.125" - 2.625"	1
22	400-3177Y1-BK	JD 1770 Fill Kit Strainer Mounting Bracket	1
23	400-3187Y1-BK	JD 1770 Rear Hitch Fill Kit Mounting Bracket	1
24	400-5918Y1-BK	JD 1775 Long Strainer Mounting Bracket	1

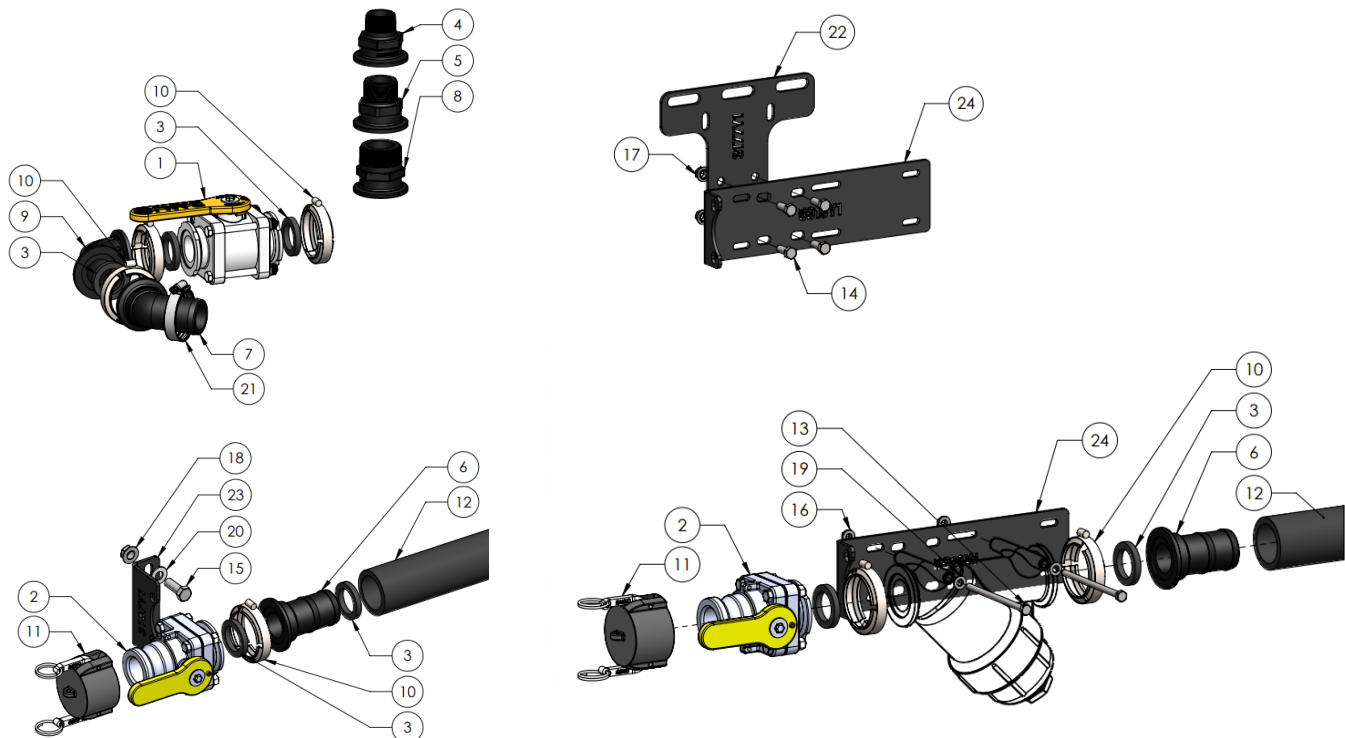

STRAINER NOT INCLUDED IN KIT

Step by Step Instructions

Rear Hitch Mounting Instructions

1. Assemble tank fittings as shown and attach to top most tank bung.
2. Remove nuts on poly valve as required to fasten valve to rear hitch mounting bracket. Re-install nuts and wrench tighten.
3. Assemble fill kit components as shown.
4. Using two (2) 1/2" x 1-1/2" hex head bolts, flat washers and nuts, attach rear hitch bracket to implement as shown.
5. Route 2" enforcer hose between hose barbs and secure with hose clamps.

Step 1

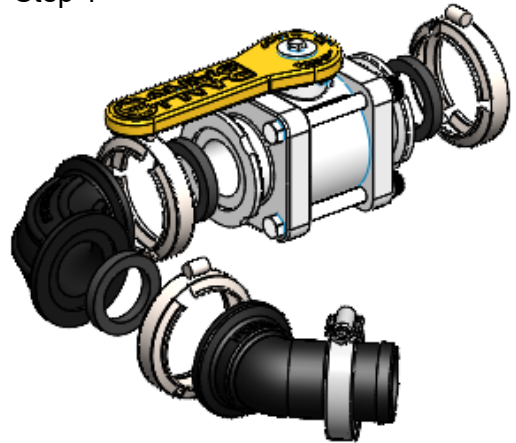

Step 1

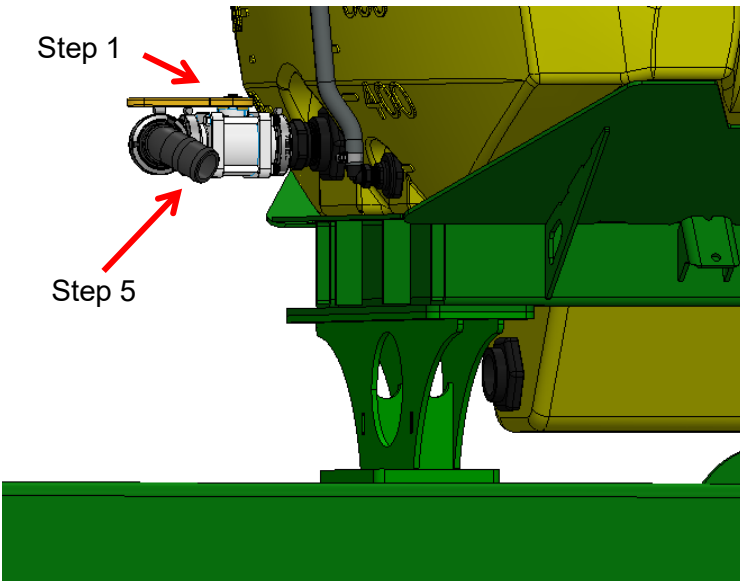

Step 5

Step 2

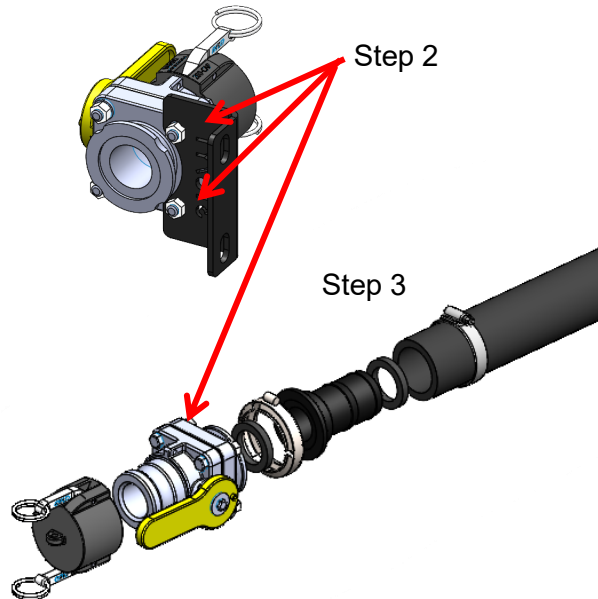

Step 3

Step 4

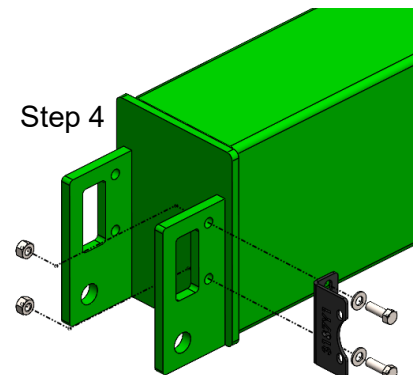

Bottom bung used for discharge. Refer to manual 396-6350Y1 for kits 520-00-103550, 520-00-103650, or 520-00-103750

Step by Step Instructions

Rear Step Mounting Instructions

Note: Strainer is not provide as part of this kit.

1. Attach strainer mounting bracket to mounting bracket using four (4) 3/8" x 1" bolts and flange nuts.
2. Remove nuts on Poly Valve as required to fasten valve to strainer mounting bracket. Re-install nuts and wrench tighten
3. Pre-assemble fill kit components as shown.

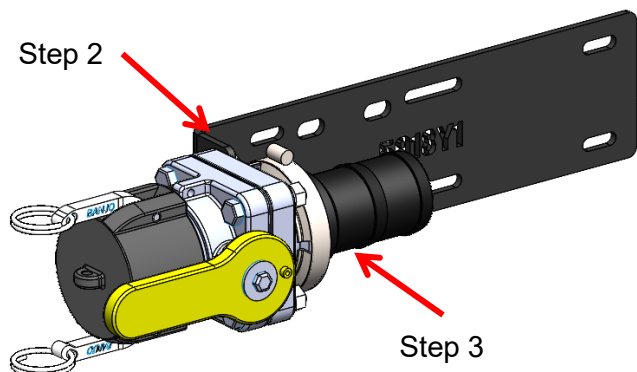
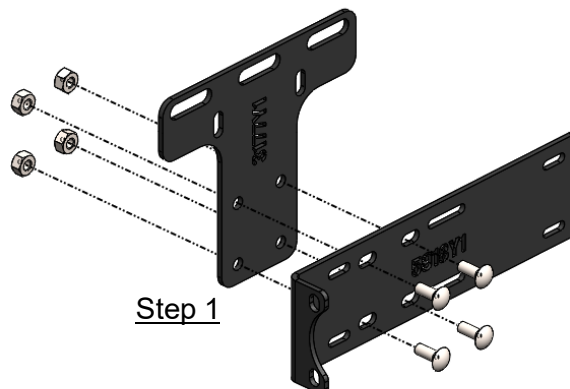

4. Remove existing bolts that fasten the lower step of the rear platform steps.
5. Mount fill kit strainer assembly and mounting bracket to rear step of John Deere 1770NT or 1775NT as shown right. Re-install bolts and wrench tighten.
6. Push 2" enforcer hose onto hose barb fittings of choice and tighten hose clamp. Route 2" hose from tank assembly hose barb to strainer assembly hose barb.

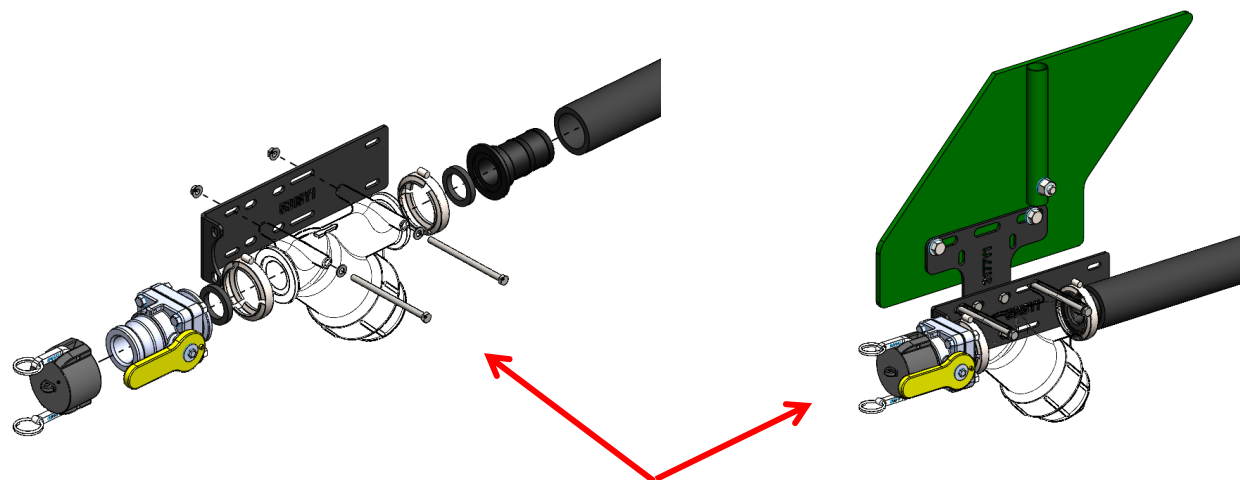
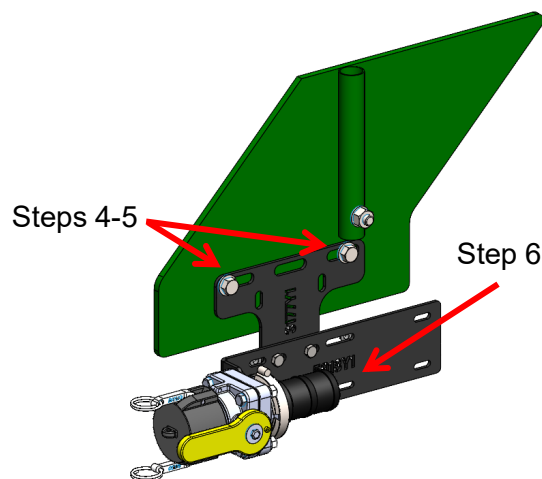

Shown with optional strainer that is NOT included in this kit.